

REVISIONS

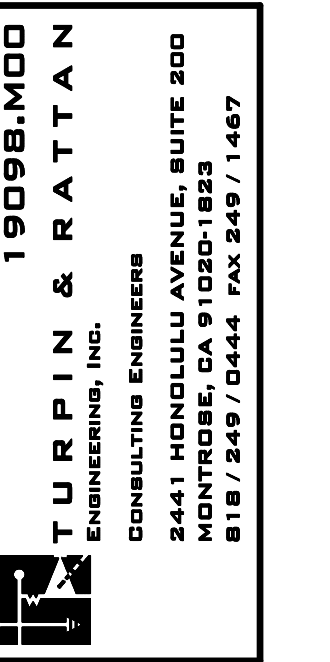

NORWALK LA MIRADA UNIFIED SCHOOL DISTRICT  
**LA MIRADA HIGH SCHOOL NEW FOOTBALL  
STADIUM PROJECT**  
13520 ADELA DRIVE, LA MIRADA, CA 90638

DSA # 03-120551

**NAC**  
ARCHITECTURE

NAC NO. 161-19015  
DATE 12/10/2020

DSA BACKCHECK  
SUBMISSION

FLOOR PLANS  
BUILDING "V" -  
LIGHTING & POWER

**E7.01**

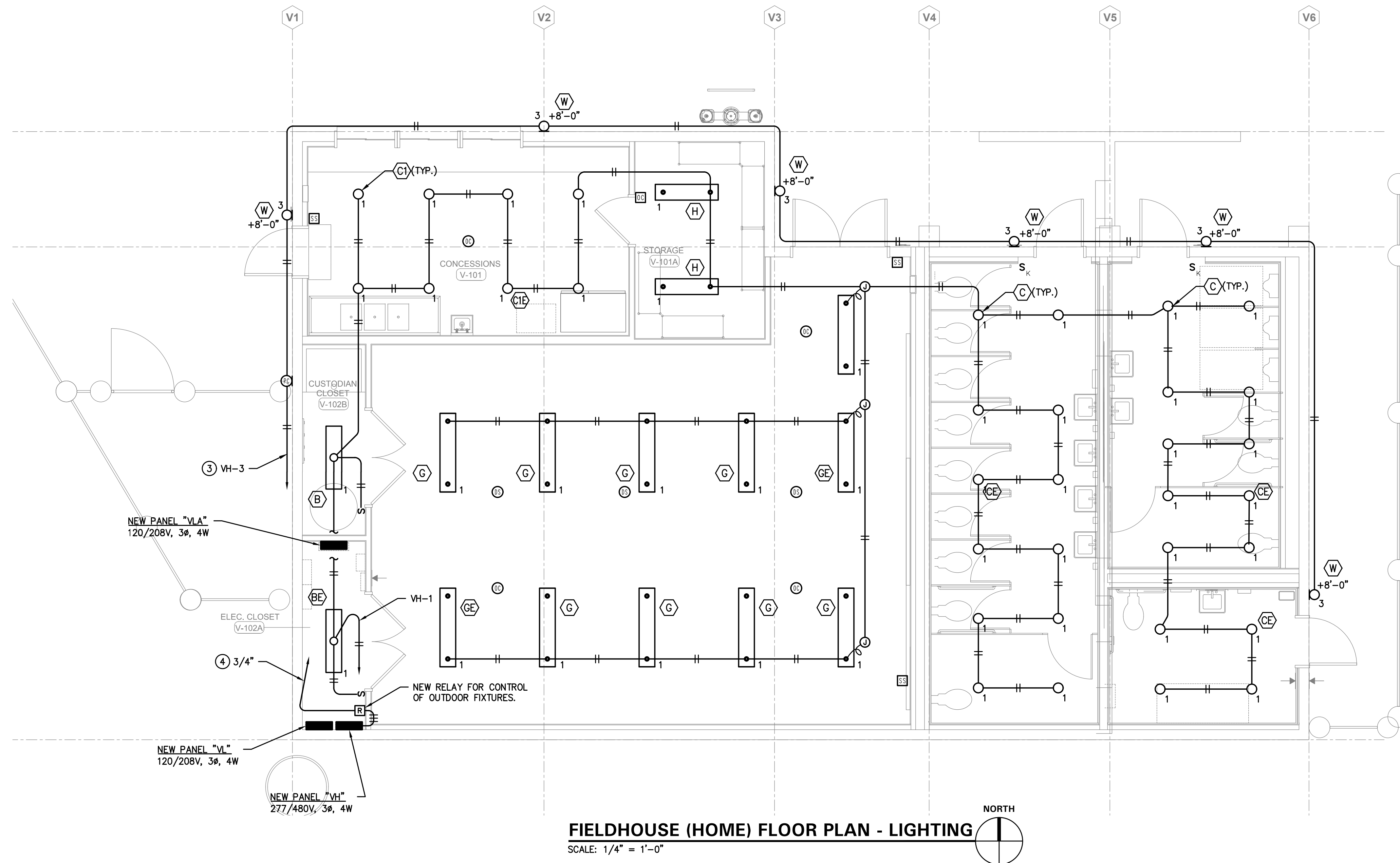

**KEY NOTES - THIS SHEET ONLY**

- REFER TO MECHANICAL CONTROL DIAGRAMS (M0.03 & M0.04) FOR CABLE/CONDUCTOR REQUIREMENTS.
- LOCATE TRANE BACNET INTERFACE, NETWORK LINK AND CONTROL PANEL IN IDF/LDF CABINET - COORDINATE LOCATION IN THE FIELD WITH CONTROLS CONTRACTOR.
- CIRCUIT FOR EXTERIOR LIGHTING SHALL BE CONNECTED TO A NEW RELAY LOCATED ADJACENT TO PANEL "VH". NEW RELAY SHALL BE CONTROLLED BY THE "AUTOMATED LOGIC CORPORATION" CONTROL SYSTEM.
- TO LDF-V, CONNECT TO NEW "ALC" CONTROLS. COORDINATE CABLE/CONDUCTOR WITH CONTROLS CONTRACTOR.

